

Facility Use Request

Application for Use of Nordby Exhibit Hall

Contact South Dakota State Fair, 605-353-7340, to confirm availability of the date requested before completing this application form.

South Dakota State Fair
1060 3rd St. SW, Huron, SD 57350
Phone: 605-353-7340 Fax: 605-353-7348

Applicant/Group	Describe the event or activity in detail. Include facility use and event/activity program information.
Contact Person	
Contact E-mail	
Contact Phone	
Contact Address (street/city/state/zip)	
Date(s) of Event	to
Time of Event	to
Room(s) Requested	Main Hall - \$1,065- 25 tables, 100 chairs Farm Credit Services Room - \$135/day - 10 tables, 80 chairs First Dakota National Bank Room - \$135/day - 10 tables, 80 chairs BankWest Room - \$135/day - 10 tables, 80 chairs First Dakota & BankWest Room (combined room) - \$190/day - 20 tables, 160 chairs SD Rural Electric Cooperatives Room - \$135/day - 10 tables, 80 chairs Kitchen - \$110

Estimated Attendance

The Nordby Exhibit Hall Use Guidelines describes the availability, requirements, restrictions, responsibilities and fees related to the use of the Exhibit Hall. By signature, user certifies that the user read, understands and agrees to all of the terms and conditions of the use guidelines.

User also agrees to indemnify and hold the State and its officers, agents, and employees harmless from any and all liability, damages, actions, claims, demands, expenses, judgements, fees and costs of whatever kind of character, arising from, by reason of, or in connection with the use of the facilities described herein. It is the intention of the parties that the State and its officers, agents and employees shall not be liable or in any way responsible for injury, damage, liability, loss or expense resulting to the user and those the user brings on the premises. User expressly assumes full responsibility for any and all damages or injuries which may result to any person or property by reason of or in conjunction with the use of the facilities pursuant to this agreement, and agrees to pay the State for all damages caused to facilities resulting from user's activities. In certain cases the South Dakota State Fair may require a Certificate of Insurance for an activity or event.

Signed

Date

SD State Fair Use Only

Approved

Signed

Date

Disapproved

Comments:

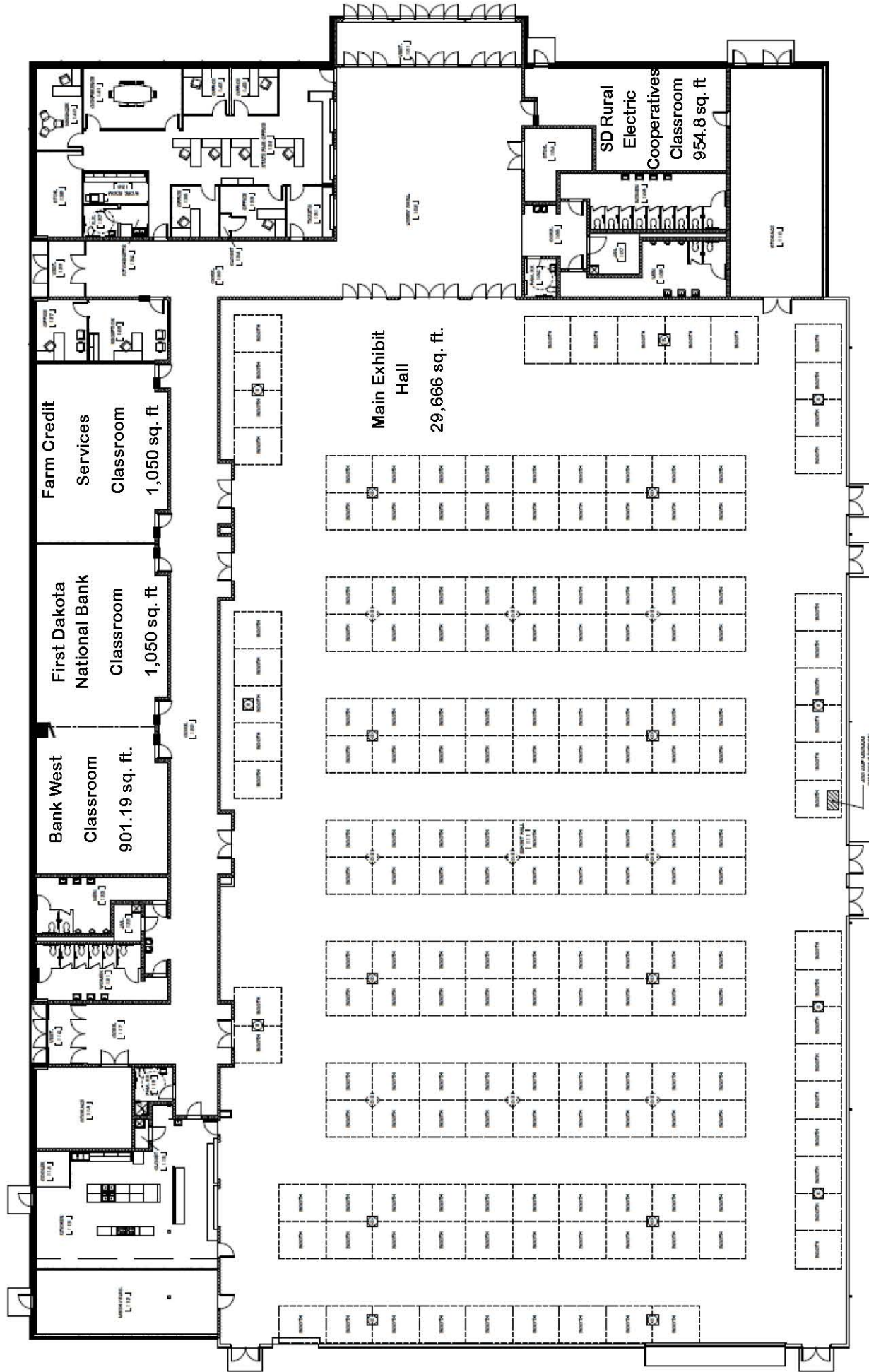

Main Exhibit Hall
29,666 sq. ft.

SD Rural Electric Cooperatives Classroom
954.8 sq. ft.

Farm Credit Services Classroom
1,050 sq. ft.

First Dakota National Bank Classroom
1,050 sq. ft.

Bank West Classroom
901.19 sq. ft.

RESTROOM

BOOTH

BOOTH

BOOTH

BOOTH

BOOTH

BOOTH

BOOTH

BOOTH

BOOTH

BOOTH

BOOTH

BOOTH

BOOTH

BOOTH